

Linda Rabbitte  
'Garrai Beag'  
Coolough,  
Menlo  
Galway

17 December 2018

<b>AN BORD PLEANÁLA</b>	
LDG	010 883 - '18
ABP-	
18 DEC 2018 LC	
Fee: €	50
Type:	cheque
Time:	—
By:	Reg Post

**VIA REGISTERED POST**

An Bord Pleanála,  
Strategic Infrastructure Division  
64 Marlborough Street  
Dublin 1, DO1 V902

**Submission Re: N6 Galway City Ring Road**

Dear Board Members,

I am a native of Menlo Village, as have been my maternal family for generations. I have built a home in Coolough, where I now reside with my family. My home is located directly adjacent to the entrance to the Lackagh Quarry site in Coolough. Accordingly, I utilize the same private entrance to gain access to my property. I enclose a map, (see Attachment No.1) and a current photo, (see Attachment No. 2) showing location of same for your ready reference.

Having viewed the N6 Galway City Ring Road planning documents online, and subsequently learning that Lackagh Quarry is the largest proposed site compound SC11/01, with a site area of 9.0 ha., my initial concerns regarding the proposed Ring Road have escalated considerably. Accordingly, my submission in relation to the Ring Road is as follows:

*Section 7.4.9.1: the earthworks will be a major activity on site and will include excavation, stockpiling, processing, deposition, blasting, material reuse, import and transportation from the site for recovery/disposal. The construction of the proposed road development will require considerable movements of materials to and from and around the site. Most of the materials leaving the site will consist off **hazardous material** from excavation works.*

With respect to Section 7.4.9.1., my concerns are principally for myself and my family's health and safety. My property has two access points onto the same private road, as the entrance to Lackagh Quarry. I have concerns that I may not safely access my property due to the increased construction traffic using this road. There are young children living in my home so the physical danger associated with the HVG/Haulage lorries on our private road is of utmost concern to me. My disabled brother spends a considerable amount of time in my home, and the construction process may be detrimental to his health and wellbeing, given that potential toxins from the construction site will pollute the air.

*Section 3.4: The Lackagh Quarry near the proposed tunnel entrance has been identified as a large material deposit area. The Lackagh tunnel is rated as representing a moderate flood risk due to existing pluvial/groundwater flood risk at Lackagh quarry. This higher risk is associated with the Lackagh tunnel as the eastern portal entrance is located at the base of*

*limestone quarry floor where there is potential for high ground water levels. Groundwater flood risk within the quarry is also compounded with pluvial flooding which occurs in periods of high intensity rainfall.*

*Page 30 Flood Risk Assessment Study states: Lackagh Quarry floor, potential flood risk as moderate. Residual flood risk as significant.*

If an estimated 15,200 tonnes of waste will be generated, 25,300 tonnes of construction waste including machinery oils/chemical cleaning solutions, and larger compounds have the potential for material stockpiling (7.4.9.4 Environmental Impact study), then storing hazardous materials in an area with increased risk of flooding has the potential to contaminate the surrounding lands/soil. It is inevitable, given the climate/weather this country experiences, that such contamination will most probably occur. See enclosed photos of flooding in Lackagh Quarry taken in January 2016 (Attachment #3). I believe that the levels of flooding in the Quarry have been underestimated in the EIA. My property is located directly adjacent to Lackagh Quarry, so how can you guarantee that I will not be impacted by such flooding? You cannot anticipate the weather so you cannot guarantee that depositing such amounts of materials in Lackagh Quarry will not directly impact us.

*Section 7.4.4.6 Page 297 Environmental Impact Assessment Report.*

*It is proposed to include concrete batching and rock crushing plant at Lackagh Quarry SC11/01. Lackagh Quarry site compound will be one of the principal site compounds across the proposed road development, given its size and location in relation to the overall proposed road development.*

*Page 782 Earthworks Haulage*

*During earthworks construction, heavily loaded large earthmoving vehicles will travel through the site, causing ground vibrations, unwanted compaction and disturbance of natural ground of unfinished road surfaces.*

*Effect on Surrounding Ground*

*Oil and rock excavation has the potential to induce movement and settlement of surrounding ground. The breaking or blasting of the bedrock could result in ground vibrations and destabilisation of existing slopes, existing rock slopes, with affects felt in the immediate vicinity of the works.*

Given the above, I am very concerned that my property will suffer structural damage from rock excavation associated with the construction of the Lackagh Quarry tunnel. Previous blasting in Lackagh Quarry has caused severe damage to neighbouring properties in the past. This, coupled with noise pollution, air pollution and dust, make for a very miserable existence for all, especially for people who already suffer from respiratory illness. Here again, you cannot guarantee that there will be no impact on health. Who will cover the extensive medical expenses that will be incurred as a result of living beside a toxic dumping ground?

I have an air-source heat pump system located at the side of my house, which runs parallel with the entrance road to Lackagh Quarry. I am very concerned that the increased dust levels from the construction process may interfere with its operation. Should the proposed Ring Road go ahead, what provisions will be put in place to ensure that no damage will occur to my home heating system? Also, be advised I will be seeking compensation for Injurious Affection if the proposed N6 Ring Road application is successful.

#### *7.7 Residual Impacts*

*Any residual impacts to the existing environment such as deterioration of public roads used as Haul routes will be repaired. Any structural damage caused to buildings/structures/wells as a result of construction will undergo a full stabilisation and rehabilitation works.*

Regarding Section 7.7, should this proposed Ring Road be approved, I demand written

evidence of the above in relation to my property and furthermore, a guarantee that the private road entering Lackagh Quarry be kept in good repair for the duration of the construction works (stated as 36 months) and thereafter as it is my only access onto the public Coolough road.

#### *Section 7.4.7.11 Environmental Impact Assessment Report*

*Access to the eastern side of this section of the proposed road development will be from Lackagh Quarry which is accessed via Coolough road and access to the western side will be from Seanbothar. It is proposed to construct a tunnel services, monitoring and maintenance building within Lackagh Quarry which will serve the function of the maintenance facility for the proposed tunnel. An emergency exit road for westbound traffic will be constructed to allow egress from the proposed road development in advance of the eastern tunnel portal if required. This will exit onto the Coolough road at the existing entrance to Lackagh Quarry. Similarly, an emergency exit road for eastbound traffic will be constructed to allow egress from the proposed road development in advance of the western tunnel portal. This emergency exit road forms part of a loop which exits onto Seanbothar and then crosses under the mainline and connects back to Bothar nua in Coolough. These emergency exit roads will primarily serve as access for emergency service vehicles with gated barrier controlled entry and exit. These will also be used in the event of an over-heighted vehicle detection to safely remove the vehicle in advance of the tunnel.*

Regarding Section 7.4.7.11, this information was not clearly marked out on the maps made available to the public in 2016. Accordingly, I was only made aware of this change in the plans in March 2017. Again, as this road is my primary access onto the public road, I have concerns regarding its usage in the future. Should the proposed road go ahead, I will require written proof that this road will **never** be made into an exit route off the N6 Galway City Ring Road, as to do so would effectively cut off my safe access from my property to the public road, thus directly endangering everyone. This private road is used regularly by numerous families.

On 14/12/18, a letter was personally delivered from an unknown representative of Galway City Council, to a member of my family. See (Attachment No. 4). This man stated to my sister that he was delivering the letter on behalf of a colleague, and that his colleague had been speaking to me earlier that day. This was completely untrue. My sister will give sworn statement to verify this. The letter, which had been opened prior to delivery! contained a compulsory acquisition order for the private road entering Lackagh Quarry, over which I have right of way to gain access to my property. **I completely object to my right of way being extinguished** as this road is my only access from my property to the public road. I seek legally binding assurance about my ongoing access to my right of way.

*The Land Reform Commission of Ireland, Issues Paper, Compulsory Acquisition of Land: Issue 7-Advertising and notifying affected land owners, The 2000 Act, (7 04) states: Under the 2000 Act, the authority must also circulate the notice to all relevant landowners, lessees and occupiers (except tenants who occupy the land for a month or less). This notice must state the timeline and the manner in which objections can be made before the CPO is submitted to An Bord Pleanála. There is no statutory time limit for objections aside from the fact that a month, at the very least, must be given to the landowner to raise such an objection. The notification procedure serves 2 purposes. The first is to display the intention to acquire the land. The second is to give the landowner forewarning of the requirement to furnish the particulars of his or her claim to the acquiring authority.*

Again, I **object** on the grounds that I was given only 1 weeks notice of this CPO, and I would consider that this **CPO is rendered invalid**, given that there was a failure to abide by these provisions.

Should the receipt of this CPO now make me a 1st Party Objector, I will expect to be reimbursed my submission fee (see cheque enclosed in the amount of €50).

*Section 9.8.6 pg 815 ...Lackagh tunnel traverses beneath Limestone pavement that is located*

*within European designated sites and will emerge into Lackagh Quarry.*

Regarding Section 9.8.6, while the planning documents state that the residual risk of the tunnelling under the cSAC is considered *imperceptible* to the Limestone pavement, I question the validity of this statement.

The area where Lackagh Quarry is located is currently zoned as Agricultural in the current Galway City Development Plan. To utilize it as a site compound for the construction of the proposed N6 Ring Road would materially change the zoning to that of Industrial. Does this contravene a flawed planning application?

There is **always** a risk of instability to the rock mass when drill and blasting techniques are used. This area is rich in flora and fauna and protected by European law. Any disturbance within this area, whether under or over the protected area, will be **detrimental** to all the species natural habitat. It is inconsequential what mitigation measures are put in place to lessen the impact, the fact remains that this area will never be the same again.

Today, Menlo Village is a beautiful, scenic area, rich in heritage. It is currently a tourist attraction with many visitors cycling out from Galway City. it is an invaluable asset to Galway City. Furthermore, Menlo Village is host to a number of protected structures namely:

AH 16 GA082-064/001 Menlo Castle

AH 41 GA082-070 Gate Lodge

AH 22 GA082-060 Pillar Stone

AH 40 GA 082-061 Burialground

As well as those listed above, there are a number of thatched cottages (protected structures) in Menlo. Coolough Village and its environs, is also rich with ancient historical features.

AH 18 GA082-031 Enclosure Coolough

AH 19 GA082-095 Ringfort Coolough

Coolough Village also has a famine village settlement, with huge potential to become a major tourist attraction, located within walking distance of Galway city. See (attachment no.5) photos of above mentioned famine village. It is my understanding that it is soon to become a protected structure. There is also a cottage which is listed as a protected structure in the heart of the Coolough village. This area is in very close proximity to Lackagh Quarry and will ultimately be damaged due to the proposed construction.

I am absolutely shocked to discover from examining the Planning Documents, to read in Appendix A 13.2 of Recorded Monuments within the receiving Environment, that a number of the 41 historical sites mentioned are to be downgraded in status. Who decides this? In this day and age where maintaining the environment is of paramount importance at local, national and international levels, it seems very foolish to destrol the little that we have left in such close proximity to Galway City.

The Gate House is located a mere 406m N/W of the proposed N6 road. Many HVG's will have to pass beside it to gain access to the land for the proposed construction. Our local burial ground is only 577m away from the proposed N6 road. The grounds surrounding Menlo Castle should be treated carefully, as they most probably contain artifacts of archeological significance.

The proposed construction of the N6 Galway City Ring Road most probably will damage all of these structures. Instead, both Menlo and Coolough should be developed in a suitable manner to enhance them so that generations to come, can enjoy them and learn from them as they boast a vast amount of information about our past. They also pose as a tourist attraction which benefits local economy.

The Seanbothar links Coolough to Menlo. It is the only safe pedestrian route available, given

the huge volume of traffic utilizing Bothar Nua as a 'rat run' daily, and the lack of a footpath/cycle lane to Menlo. See( Attachment No. 6), email from a project engineer working for Arup, stating there will be no restrictions to pedestrian access over Sean Bothar. I would like assurances that this will be upheld. Other ancient walkways exist running adjacent to the Lackagh Quarry and my own property. All Public rights of way around this area must be maintained. Destroying these boreens in the name of progress is an absolute travesty. These natural greenways located within walking distance from Galway City centre should be preserved and protected as a natural amenity for all residents of Galway City.

Alternatives to this proposed N6 Galway City Ring Road must be revisited. There has to be a better, less destructive way to combat the traffic congestion problem that Galway city undeniably has. For example, a light rail system similar to those used in every other European city. Or instead of crossing the River Corrib, utilize the natural waterways for transport/amenity purposes. Reopen the old rail network to Clifden. Push the location of the N6 Galway city bypass out further where its environmental impact will be less.

Given the National need to lower the level of greenhouse gas emmissions as outlined in Chapter 2 Planning and Policy, the Climate Action and Lower Carbon Development Act, we need to look towards reducing the number of single vehicles on roads and utilize more shared transport systems, ie buses/rail/trams/cycle lanes/car pooling.

This proposed N6 Galway City Ring Road in its current location is absolutely **not** the answer. The sacrifice of irreplaceable historical monuments and destruction to our city's precious environmental assets/wildlife and greenways is far too big a price to pay.

Please acknowledge receipt of the enclosed. I await your response to the queries raised herein at your earliest convenience.

Sincerely,



Linda Rabbitte

LR/

w/enclosures







# ATTACHMENT No 1

ATTACHMENT No. 1

## PHASE 3 - DESIGN

### Legend

-  Pre-Earthworks Drainage
-  Structures
-  Development Boundary
-  Landowner Plot
-  N6 GCRR Road Design

MY PROPERTY  
= YELLOW

ENTRANCE ROAD  
TO LACKASH  
QUARRY  
= PINK

Note 1: Pre-Earthworks Drainage (PED) refers to interception ditches that intercept the overland flow from the natural catchment, adjacent to the proposed scheme

Note 2: The following is a non exhaustive list of items excluded from the drawing at this time as the design is ongoing:  
Noise Barriers, Safety Barriers, Drainage Pipes and Accomodation Works

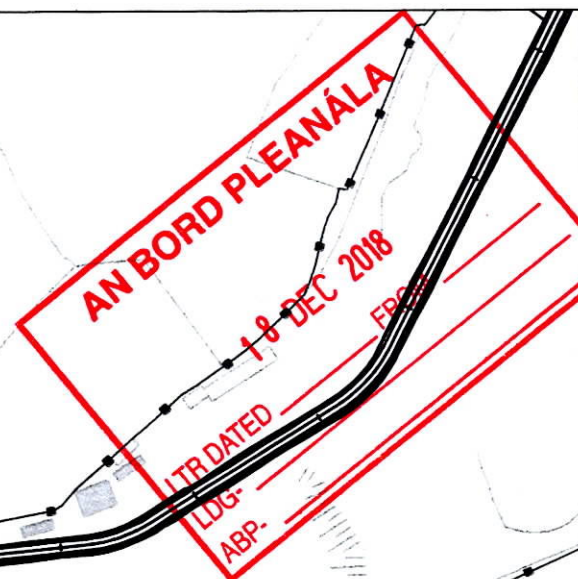

ATTACHMENT No. 2

ATTACHMENT No. 2. PHOTOGRAPH SHOWING ENTRANCE ROAD TO LACKAGH QUARRY  
AND MY PROPERTY.



# ATTACHMENT No. 3

## FLOODING IN LACKAGH QUARRY



Image 1 taken January 2016



Image 2: Tidal marks from seasonal flooding at Coolough Quarry





Comhairle Chontae na Gaillimhe  
Galway County Council



Comhairle Cathrach na Gaillimhe  
Galway City Council

Tel: [REDACTED]

23/11/2018

ATTACHMENT No. 4

**PRIVATE & CONFIDENTIAL**

Linda Rabbitte  
13 St. Patrick's Ave  
Eyre Square  
Galway

**Re: N6 Galway City Ring Road Motorway Scheme 2018**

**Landowner Ref Number: O\_583.3**

It has come to our attention that you may have an interest in terms of a right of way over Plot 583b.203 which is part of the N6 Galway City Ring Road Motorway Scheme. Please find enclosed the relevant documentation serving notice on you in respect of the proposal for this right of way under the above-mentioned Motorway Scheme.

Please do not hesitate to contact the undersigned should you have any queries.

Is mise le meas,

*Fintan O'Meara*

Fintan O'Meara

Project Engineer N6 Galway City Ring Road  
Galway National Roads Project Office (Galway County Council), Corporate House, City East  
Business Pk, Ballybrit, Galway H91 KT67





Comhairle Chontae na Gaillimhe  
Galway County Council



Comhairle Cathrach na Gaillimhe  
Galway City Council

**FORM OF NOTICE TO BE SERVED ON PERSONS REFERRED TO IN  
SECTION 48(b) OF THE ROADS ACT 1993 (INSERTED BY SECTION 9(1)(b)  
OF THE ROADS ACT 2007) BEFORE SUBMITTING A SCHEME TO AN  
BORD PLEANALA**

**GALWAY COUNTY COUNCIL**

**N6 Galway City Ring Road Motorway Scheme 2018**

To Linda Rabbitte  
13 St. Patrick's Ave  
Eyre Square  
Galway

Ref. No. 583

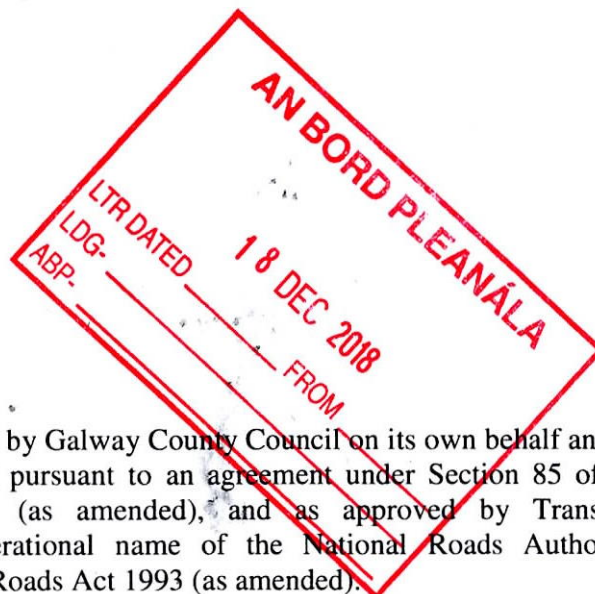

This scheme is being undertaken by Galway County Council on its own behalf and on behalf of Galway City Council pursuant to an agreement under Section 85 of the Local Government Act 2001 (as amended), and as approved by Transport Infrastructure Ireland (the operational name of the National Roads Authority) pursuant to section 14(8) of the Roads Act 1993 (as amended).

1. Galway County Council (the 'road authority') under Section 47 of the Roads Act 1993, as amended, has made the N6 Galway City Ring Road Motorway Scheme 2018 which it proposes to submit to An Bord Pleanála for approval. The scheme relates to the proposed provision a new dual carriageway, consisting of 2 lanes and a hard shoulder in each direction divided by a segregating barrier, new link roads, the realignment/improvement of regional, county and local roads crossed by the proposed scheme and localised works to the existing electricity transmission and distribution networks (specifically comprising of the diversion of the 110kv and 38kv services), together with all ancillary and consequential works associated therewith. The proposed road development would be located in the County Galway divisions of:

- (i) Bearna [i bParóiste Dlí Rathún]/Barna [in the Civil Parish of Ragoon], (ii) Rathún/Ragoon, (iii) An Daingean/Dangan, (iv) Mionlach/Menlough, (v) An Caisleán Gearr/Castlegar, (vi) Baile an Teampaill/Ballintemple, (vii) Baile an Bhriotaigh/Ballybrit, (viii) An Baile Bán/Ballybaan

and passing through the townlands of:

(i) Rathún/Rahoon, (ii) Leitreach/Letteragh, (iii) Barr na Crannaí/Barnacranny, (iv) An Bealach/Ballagh, (v) Páirc na Sceach/Bushypark, (vi) An Daingean Uachtair/Dangan Upper, (vii) An Daingean Íochtair/Dangan Lower, (viii) Mionlach/Menlough, (ix) Cúil Each [sa toghroinn Mionlach]/Coolagh [in the electoral division of Menlough], (x) Baile an Dúlaigh/Ballindooly, (xi) An Caisleán Gearr/Castlegar, (xii) Ceapach na Boirne/Cappanabornia, (xiii) An Pháirc Mhór/Parkmore, (xiv) Baile an Bhriotaigh/Ballybrit, (xv) An Poll Caoin/Pollkeen, (xvi) An Bhrocach/Brockagh, (xvii) Dabhach Uisce/Doughiska, (xix) An Bréanlochán/Breanloughaun, (xx) Cúil Each [sa toghroinn An Baile Bán]/Coolagh [in the electoral division of Ballybaan], (xxi) An Garrán Thuaidh/Garraun North, (xxii) An Baile Bán Beag/Ballybaan Beg

2. For the purposes of the scheme, it is proposed to: compulsorily acquire certain land or substratum of land and certain rights in relation to land; extinguish certain public and private rights of way; prohibit, close, stop up, remove, alter, divert or restrict a means of direct access to or from the proposed motorway; and revoke certain planning permissions for the development of land.

3. For more information on the nature and extent of the scheme, a copy of the scheme and map referred to in it may be inspected at the locations listed below during the opening hours listed below (with the exception of public holidays) from the 25th October 2018 to the 21st December 2018:

(i) The Offices of Galway County Council, Áras an Chontae, Prospect Hill, Galway. Opening hours: Monday to Friday - 9am to 4pm (Tel: 091 509000)

(ii) The Offices of Galway City Council, City Hall, College Road, Galway. Opening hours: Monday to Friday - 9am to 4pm (Tel: 091 536400)

(iii) Westside Library, Seamus Quirke Road, Galway. Opening hours: Monday - 2pm to 5pm; Tuesday, Wednesday & Thursday - 11am to 5pm; Friday & Saturday - 11am to 5pm (Tel: 091 520616)

(iv) Galway City Centre Library, St. Augustine Street, Galway. Opening hours: Tuesday, Thursday & Friday - 11am to 5pm; Wednesday - 11am to 8pm; Saturday - 11am to 1pm & 2pm to 5pm (Tel: 091 561666)

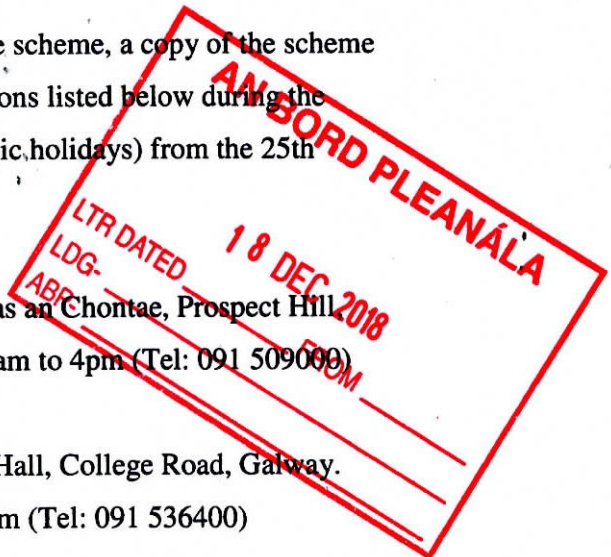

(v) Galway National Roads Project Office (Galway County Council),  
Corporate House, City East Business Park, Ballybrit, Galway. Opening hours:  
Monday to Friday – 9am to 4pm (Tel: 091 509594)

(vi) The Offices of An Bord Pleanála, 64 Marlborough Street, Dublin 1.  
Opening hours: Monday to Friday - 9.15am to 5.30pm (Tel: 01 8588100)

4. The extract from the scheme and accompanying map attached to this notice give details of the land/rights in relation to the land/rights of way/means of direct access referred to in the scheme in which you have an interest or the proposed revocation of planning permissions specified in the scheme which may affect you.

5. Objections may be made in writing to An Bord Pleanála (Strategic Infrastructure Division), 64 Marlborough Street, Dublin 1, D01 V902 between 25th October 2018 and the 21st December 2018.

Dated the 23<sup>rd</sup> November 2018

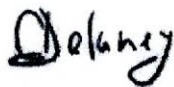

---

Celine Delaney  
Acting Senior Executive Officer  
Corporate Service



Áras an Chontae,  
Cnoc na Radharc, Gaillimh.  
H91 H6KX.

Áras an Chontae,  
Prospect Hill, Galway.  
H91 H6KX.

Fón/Phone: (091) 509 000  
Facs/Fax: (091) 509 010  
Idirlíon/Web: [www.gaillimh.ie](http://www.gaillimh.ie)  
[www.galway.ie](http://www.galway.ie)

@GalwayCoCo  
GalwayCounty

Tithíocht  
Housing  
(091) 509 300  
[housing@galwaycoco.ie](mailto:housing@galwaycoco.ie)

Deontais Tithíochta  
Housing Grants  
(091) 509 301  
[housing@galwaycoco.ie](mailto:housing@galwaycoco.ie)

Seirbhísí Corparáideacha  
Corporate Services  
(091) 509 225  
[corpserv@galwaycoco.ie](mailto:corpserv@galwaycoco.ie)

Timpeallacht & Tréidliachta  
Environment & Veterinary  
(091) 509 510  
[environment@galwaycoco.ie](mailto:environment@galwaycoco.ie)

Bóithre, Iompar & Muiri  
Roads, Transportation & Marine  
(091) 509 309  
[roads@galwaycoco.ie](mailto:roads@galwaycoco.ie)

Acmhainní Daonna  
Human Resources  
(091) 509 303  
[hr@galwaycoco.ie](mailto:hr@galwaycoco.ie)

Mótarcháin  
Motor Taxation  
(091) 509 099  
[motortax@galwaycoco.ie](mailto:motortax@galwaycoco.ie)

Clár na dToghthóirí  
Register of Electors  
(091) 509 310  
[electors@galwaycoco.ie](mailto:electors@galwaycoco.ie)

Seirbhísí Uisce  
Water Services  
(091) 509 505  
[water@galwaycoco.ie](mailto:water@galwaycoco.ie)

Pobal & Fiontar  
Community & Enterprise  
(091) 509 521  
[community@galwaycoco.ie](mailto:community@galwaycoco.ie)

Pleanáil  
Planning  
(091) 509 308  
[planning@galwaycoco.ie](mailto:planning@galwaycoco.ie)

Leabharlann  
Library  
(091) 562 471  
[info@galwaylibrary.ie](mailto:info@galwaylibrary.ie)



## Comhairle Chontae na Gaillimhe Galway County Council

Don té a mbaineann sé:

To Whom It May Concern:

### Ráiteas Príobháideachta

### Cuarbhóthar N6 Chathair na Gaillimhe

Sa ráiteas príobháideachta ar [www.n6galwaycityringroad.ie](http://www.n6galwaycityringroad.ie) leagtar amach na sonraí maidir leis an bhfaisnéis phearsanta a bhaineann leat atá againn agus a úsáidimid, na críocha dá n-úsáidimid é, do chearta maidir le d'fhaisnéis phearsanta agus sonraí gaolmhara.

### Privacy Statement

### N6 Galway City Ring Road

Details regarding the personal information relating to you that we hold and use, the purposes for which we use it, your rights in relation to your personal information and related details are set out in the privacy statement on [www.n6galwaycityringroad.ie](http://www.n6galwaycityringroad.ie).

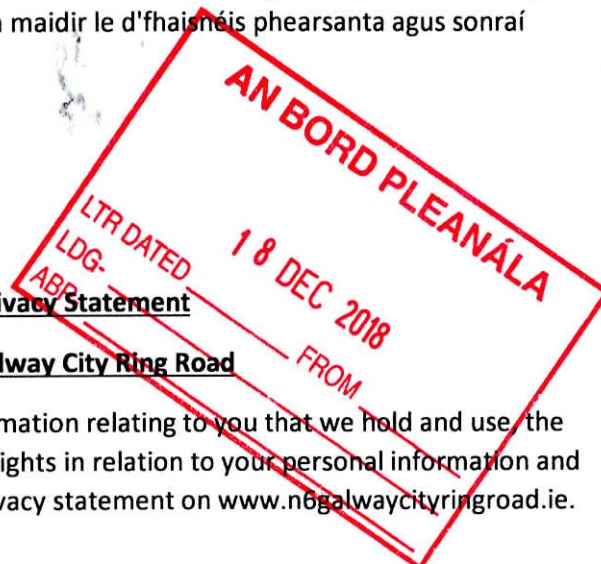

Áras an Chontae,  
Cnoc na Radharc, Gaillimh.  
H91 H6KX.

Áras an Chontae,  
Prospect Hill, Galway.  
H91 H6KX.

Fón/Phone: (091) 509 000  
Facs/Fax: (091) 509 010  
Idirlíon/Web: [www.gaillimh.ie](http://www.gaillimh.ie)  
[www.galway.ie](http://www.galway.ie)

@GalwayCoCo  
GalwayCounty



## Comhairle Chontae na Gaillimhe Galway County Council

Don té a mbaineann sé:

To Whom It May Concern:

Seirbhísí Corparáideacha  
Corporate Services  
(091) 509 225  
[corpserv@galwaycoco.ie](mailto:corpserv@galwaycoco.ie)

Tithíocht  
Housing  
(091) 509 300  
[housing@galwaycoco.ie](mailto:housing@galwaycoco.ie)

Timpeallacht & Tréidliacht  
Environment & Veterinary  
(091) 509 510  
[environment@galwaycoco.ie](mailto:environment@galwaycoco.ie)

Bóithre, Iompar, Cúrsaí Mara  
& Seirbhísí Ginearálta  
Roads, Transportation, Marine  
& General Services  
(091) 509 309  
[roads@galwaycoco.ie](mailto:roads@galwaycoco.ie)

Acmhainní Daonna  
Human Resources  
(091) 509 303  
[hr@galwaycoco.ie](mailto:hr@galwaycoco.ie)

Mótarcháin  
Motor Taxation  
(091) 509 099  
[motortax@galwaycoco.ie](mailto:motortax@galwaycoco.ie)

Clár na dToghthóirí  
Register of Electors  
(091) 509 310  
[electors@galwaycoco.ie](mailto:electors@galwaycoco.ie)

Seirbhísí Uisce  
Water Services  
(091) 509 505  
[water@galwaycoco.ie](mailto:water@galwaycoco.ie)

Pobal & Fiontar  
Community & Enterprise  
(091) 509 521  
[community@galwaycoco.ie](mailto:community@galwaycoco.ie)

Pleanáil  
Planning  
(091) 509 308  
[planning@galwaycoco.ie](mailto:planning@galwaycoco.ie)

Leabharlann  
Library  
(091) 562 471  
[info@galwaylibrary.ie](mailto:info@galwaylibrary.ie)

### Cuarbhóthar N6 Chathair na Gaillimhe

#### Soiléiriú

#### Uaireanta Oscailte Leabharlainn

(iii) Leabharlann an Taoibh Thiar, Bóthar Shéamais Uí Chuirc, Gaillimh.

Uaireanta Oscailte: Dé Máirt, Déardaoin & Dé hAoine - 11am go dtí 5pm; Dé Céadaoin - 11am go dtí 8pm; Dé Sathairn - 11am go dtí 1pm & 2pm go dtí 5pm (Teil: 091 520616)

(iv) Leabharlann Chathair na Gaillimhe, Sráid San Aibhistín, Gaillimh.

Uaireanta Oscailte: Dé Luain - 2pm go dtí 5pm; Dé Máirt, Dé Céadaoin & Déardaoin - 11am go dtí 8pm; Dé hAoine & Dé Sathairn - 11am go dtí 5pm (Teil: 091 561666)

**N6 Galway City Ring Road**

#### Clarification

#### Library Opening Hours

(iii) Westside Library, Seamus Quirke Road, Galway. Opening hours:

Tuesday, Thursday & Friday – 11am to 5pm; Wednesday – 11am to 8pm;  
Saturday – 11am to 1pm & 2pm to 5pm (Tel: 091 520616)

(iv) Galway City Centre Library, St. Augustine Street, Galway. Opening hours:

Monday – 2pm to 5pm; Tuesday, Wednesday & Thursday – 11am to 8pm;  
Friday & Saturday – 11am to 5pm (Tel: 091 561666)

LAND OR SUBSTRATUM OF LAND PROPOSED TO BE COMPLUSORILY ACQUIRED  
AN TALAMH NÓ AN FO-STRATAM TALÚN A BHEARTAÍTEAR A FHÁIL GO HÉIGEANTACH

## Part 2

## Roinn 1

## Section 1

Land (other than land consisting of a house or houses unfit for human habitation and not capable of being rendered fit for human habitation at reasonable expense)

		Galway
		Linda Rabitte 13 St. Patrick Avenue Byre Square Galway

AN BORD PLEANÁLA

18 DEC 2018

LTR DATED \_\_\_\_\_

LDG- \_\_\_\_\_

ABP- \_\_\_\_\_ FROM \_\_\_\_\_

176

**SCHEDULE 3**

**SCEIDEAL 3**

**TUAIRISC AR AN GCEART SLÍ POIBLÍ AGUS AR AN GCEART SLÍ PRÍOBHÁIDEACH A BHEARTAÍTEAR A MHÚCHADH**

**DESCRIPTION OF THE RIGHTS OF WAY PROPOSED TO BE EXTINGUISHED**

Cuid 2

Part 2

Cearta slí príobháideacha a bheartaítear a mhúchadh ar thalamh a thuairiscítear i Sceideal 1 agus 2

Private rights of way proposed to be extinguished over land described in Schedules 1 and 2

Uimhir thagartha Reference number	Tuairisc Description	Úinéir nó úinéir ainme na Cearta le fáil Owners or reputed owners of the Right to be Acquired
5	<p>An chuid sin den cheart slí poiblí i mBaile Fearainn Chóil Each i dtoghroinn Mhionlaigh agus Chontae na Gaillimhe agus idir na línte SC1 go SC2 a léirítear ar Líníocht Uimh. N6-DM-1003 den mhapa taiscthe.</p> <p>That section of the private right of way in the Townland of Coolagh in the Electoral Division of Menlough and the County of Galway and between the lines SC1 and SC2 shown on Drawing No. - N6-DM-1003 of the deposited map.</p>	<p>Geard Connell Oidhri, sannadh, ceadúnais &amp; cuireadh Heirs, assigns, licenceses &amp; invitees Coolagh Menlo Galway</p> <p>Breege-Ann and Martin Cronin Coolagh Terryland Galway</p> <p>Jacinta &amp; Patrick J. Forde Coolough Terryland Galway</p> <p>Linda Rabitte 13 St. Patrick Avenue Eyre Square Galway</p>

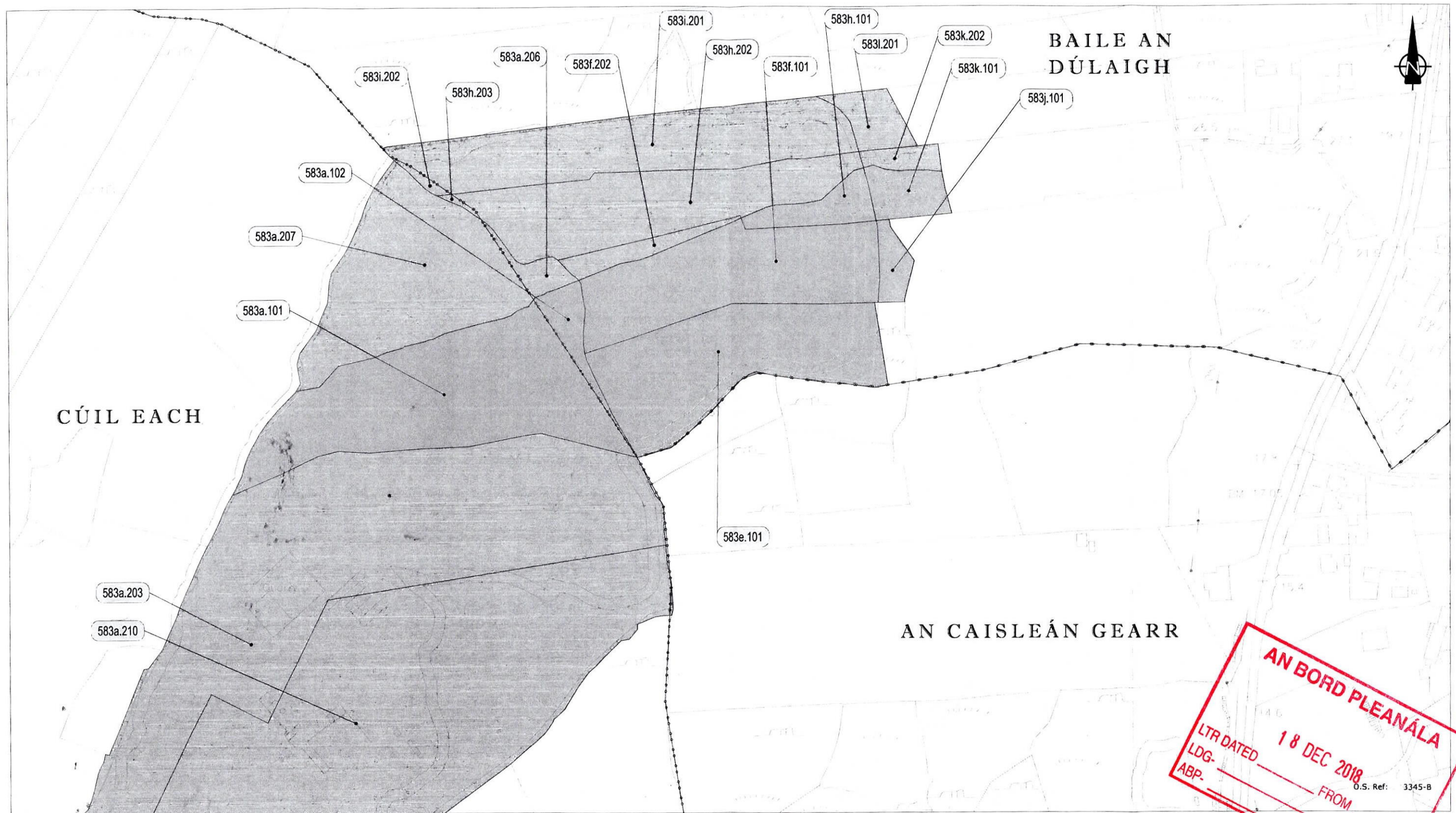

**AN BORD PLEANÁLA**  
 LTR DATED **18 DEC 2018**  
 LDG-  
 ABP-  
 FROM  
 O.S. Ref: 3345-B

**Legend:**

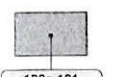

\* SCHEDULE 1: Part 1 (Shaded in Blue)  
 (Lands proposed to be compulsory acquired to provide a motorway)



Wayleaves and Rights of Access under SCHEDULE 2



\* SCHEDULE 1: Part 2 (Shaded in Grey)  
 (Lands proposed to be compulsory acquired not forming part of a motorway)



Public and private rights of way to be extinguished under SCHEDULE 3



Lands affected under SCHEDULE 4



Motorway Termination Points



Planning Permissions which have been revoked or modified under SCHEDULE 7



Townland Boundary  
 Note:  
 Townland Boundaries shown have been abstracted from Ordnance Survey Mapping and may not relate to existing features as surveyed.

Includes Ordnance Survey Ireland data reproduced under OSI Licence number 2010/18CCMA/Galway County Council. Unauthorised reproduction infringes Ordnance Survey Ireland and Government of Ireland copyright.  
 © Ordnance Survey Ireland, 2010.  
 © Ordnance Survey Ireland. All rights reserved. Licence number 2010/18CCMA/Galway County Council.  
 Sain áireamh tá sonraíocht Shuirbhíreacht Ordánais Éireann arna atáirgeadh faoi Cheadúnas OSI Uimh 2010/18CCMA/Comhairle Contae na Gaillimhe.  
 Sáráilann atáirgeadh neamhdaraithe cóipeacht Shuirbhíreacht Ordánais Éireann agus Rialtas na hÉireann.  
 © Shuirbhíreacht Ordánais Éireann, 2010.  
 © Shuirbhíreacht Ordánais Éireann. Gach ceart ar chosaint. Uimhir cheadúnais 2010/18CCMA/Comhairle Contae na Gaillimhe.



**GALWAY COUNTY COUNCIL**  
 Comhairle Chontae na Gaillimhe  
 Áras an Chontae, Prospect Hill,  
 Galway  
 H91 H6KX



**GALWAY CITY COUNCIL**  
 Comhairle Cathrach na Gaillimhe  
 City Hall, College Road,  
 Galway  
 H91 X4KN

**GALWAY COUNTY COUNCIL**  
**N6 Galway City Ring Road Motorway Scheme 2018**  
 Server Map

Rev	Date	Description	Appr

Server Map			
LACKAGH ROCK QUARRIES LIMITED and MPH Group			
Sheet 2 of 2			
Designed:GDD	File Name:	Drawing No	Rev
Drawn: KK	N6GCR Server Map MQ_550x600,223,500,470-472,648,649.dwg	N6-SM-583.2	11
Checked: MH	Scale:		
Approved:EMC	Date:		
	1:2500 (A3)		
	28/09/2018		

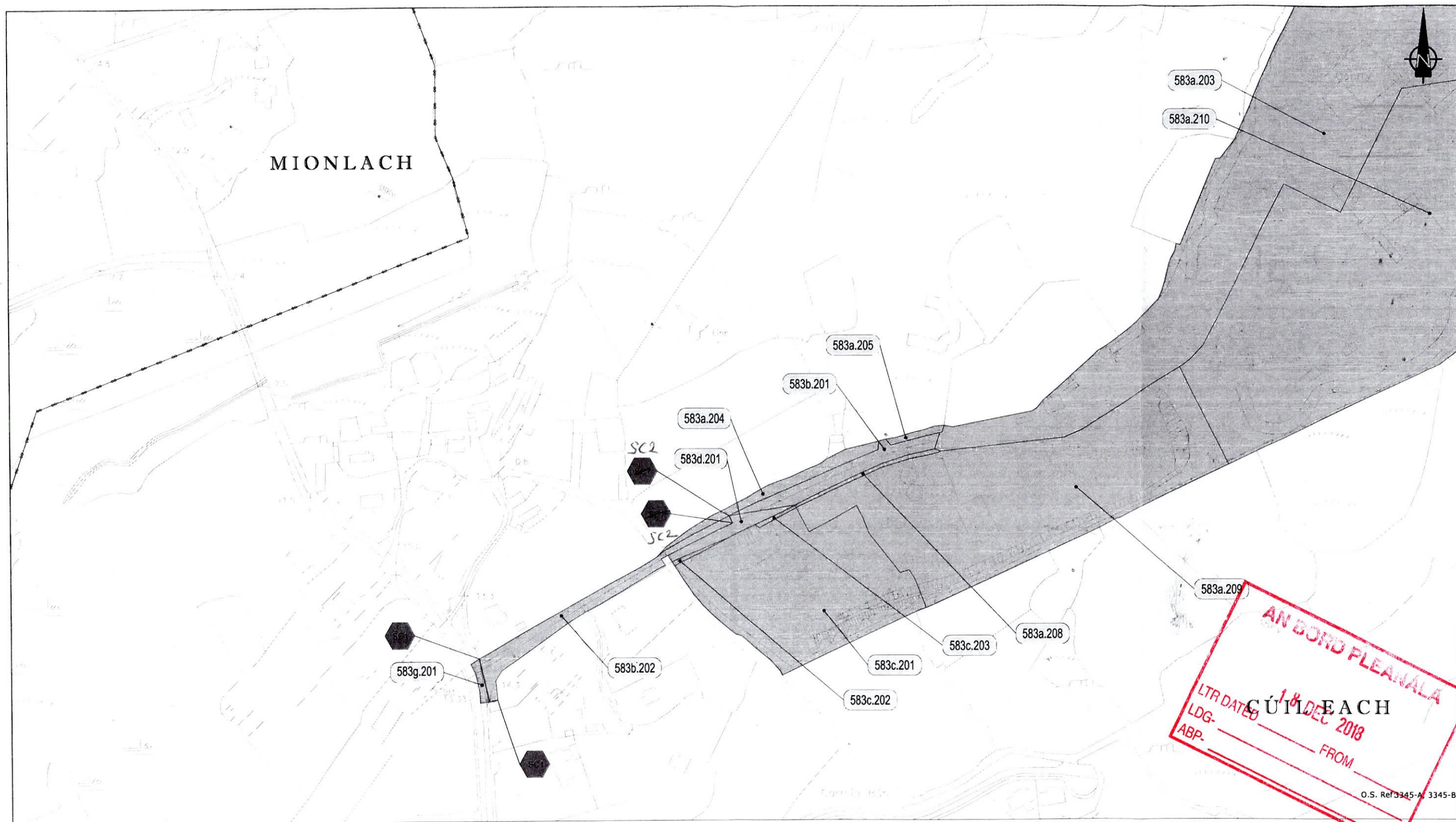

**Legend:**

- \* SCHEDULE 1: Part 1 (Shaded in Blue)  
(Lands proposed to be compulsory acquired to provide a motorway)
- \* SCHEDULE 1: Part 2 (Shaded in Grey)  
(Lands proposed to be compulsory acquired not forming part of a motorway)
- 100a.101
- Wayleaves and Rights of Access under SCHEDULE 2
- Public and private rights of way to be extinguished under SCHEDULE 3
- Motorway Termination Points
- Planning Permissions which have been revoked or modified under SCHEDULE 7
- Townland Boundary  
Note: Townland Boundaries shown have been abstracted from Ordnance Survey Mapping and may not relate to existing features as surveyed.

Includes Ordnance Survey Ireland data reproduced under OSI Licence number 2010/18CCMA/Galway County Council. Unauthorised reproduction infringes Ordnance Survey Ireland and Government of Ireland copyright.  
© Ordnance Survey Ireland, 2010.  
© Ordnance Survey Ireland. All rights reserved. Licence number 2010/18CCMA/Galway County Council

Son áireamh tá sonraíocht Shuirbhíreacht Ordánais Éireann arna atáirgeadh faoi Cheadúnas OSI Uimh 2010/18CCMA/Comhairle Contae na Gaillimhe.  
Sáraíonn atáirgeadh neamhdaraithe cóipeacht Shuirbhíreacht Ordánais Éireann agus Rialtas na hÉireann.  
© Shuirbhíreacht Ordánais Éireann, 2010.  
© Shuirbhíreacht Ordánais Éireann. Gach ceart ar chosaint. Uimhir cheadúnas 2010/18CCMA/Comhairle Contae na Gaillimhe.

**GALWAY COUNTY COUNCIL**  
Comhairle Chontae na Gaillimhe  
Áras an Chontae, Prospect Hill,  
Galway  
H91 H6KX

**GALWAY CITY COUNCIL**  
Comhairle Cathrach na Gaillimhe  
City Hall, College Road,  
Galway  
H91 X4K8

**GALWAY COUNTY COUNCIL**

**N6 Galway City Ring Road Motorway Scheme 2018**

Server Map

Rev	Date	Description	Appr

**Server Map**

**LACKAGH ROCK QUARRIES LIMITED and MPH Group**

Sheet 1 of 2

Designed: GGD  
Drawn: KK  
Checked: MH  
Approved: EMC

File Name: NSGRR Server Map MO\_55010600\_223.500\_470-472.648.649.dwg  
Scale: 1:2500 (A3)  
Date: 28/09/2018

Drawing No: N6-SM-583.1  
Rev: 11

ATTACHMENT No. 5.

CURRENT PHOTOGRAPHS OF COOLOUGH FAMINE VILLAGE



**AN BORD PLEANÁLA**

**18 DEC 2018**

LTR DATED \_\_\_\_\_ FROM \_\_\_\_\_

LDG- \_\_\_\_\_

ABP- \_\_\_\_\_

**AN BORD PLEANÁLA**

**18 DEC 2018**

LTR DATED \_\_\_\_\_ FROM \_\_\_\_\_

LDG- \_\_\_\_\_

ABP- \_\_\_\_\_



ATTACHMENT No. 6

Máire Farmer

**GCTP\_8277 An encroachment into the Coolough Ghaeltacht right-of way**

2 messages

**N6 Galway City Transport Project** <N6GCOB@arup.com>

Fri, Apr 28, 2017 at 4:10 PM

To: "galwaycommunitydevelopment@arup.com"

Cc: Eileen McCarthy, Mary Hurley, Fintan O'Meara

Sean Devaney

Peadar,

Thank you for your email on behalf of the Galway Community Development Alliance.

The current design of the N6 Galway City Ring Road (GCRR) in the Menlo/Coolough area can be found at the following links on the project website:

<http://www.n6galwaycity.ie/wp-content/uploads/2016/11/GCOB-SK-D-763.pdf>

<http://www.n6galwaycity.ie/wp-content/uploads/2016/11/GCOB-SK-D-764.pdf>

Could you please provide more detail as to the where the restriction/curtailment which you are referring to is occurring? From the description in your letter I have presumed that you are referring to Sean Bóthar and the boreen which goes from Coolough Village to the Galway City Council owned pitches which are accessed through the Crestwood housing estate. Please find the details below of the proposed design in that area:

- The existing access along Sean Bóthar, from Menlo to Bóthar Nua, is remaining intact as the mainline for the N6 GCRR is crossing over Sean Bóthar on a bridge structure
- The existing access from Coolough Village toward the Galway City Council owned pitches, which passes by the entrance to Lackagh Quarry, will remain intact.

Based on the current design there will be no restriction, curtailment or extinguishment of access along the aforementioned access routes. Please let me know if this is not the correct route, a map or drawing highlighting same would be appreciated.

Please let me know if you have any queries.

Kind regards,

Clíodhna

Clíodhna Ní Mhurchú

Project Engineer

Arup

Corporate House City East Business Park Ballybrit Galway H91 K5YD Ireland

t +353 91 894 700

[www.arup.com](http://www.arup.com)

**AN BORD PLEANÁLA****18 DEC 2018**

LTR DATED \_\_\_\_\_ FROM \_\_\_\_\_

LDG- \_\_\_\_\_

ABP- \_\_\_\_\_